



100

ART.  
100/1

**IT** Valvola manuale ad angolo per tubo ferro, con autotenuta sul bocchettone. Art. 100 senza autotenuta sul bocchettone.

**EN** Manual angle valve for iron pipe, with self-sealing on the tailpiece. Art. 100 without self-sealing on the tailpiece.

**FR** Robinet manuel équerre pour tube en fer, avec auto-étanchéité sur le raccord. Art. 100 sans auto-étanchéité sur le raccord.

**RU** Угловой ручной клапан для железной трубы, с уплотнительным кольцом. Art. 100 БЕЗ уплотнительного кольца.

Art.	3/8"	1/2"	3/4"
100/1-03	10	10	10
100/1-04	10	10	10
100/1-05	10	10	10
100-03	10	10	10
100-04	10	10	10
100-05	10	10	10

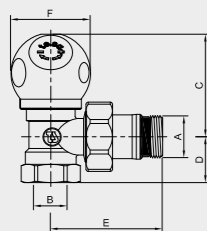

Art.	A	B	C	D	E	F
100/1-03	3/8"	3/8"	49	20	50	Ø39
100/1-04	1/2"	1/2"	49	23	54	Ø39
100/1-05	3/4"	3/4"	49	26	60	Ø39



101

ART.  
101/1

**IT** Detentore ad angolo per tubo ferro, con autotenuta sul bocchettone. Art. 101 senza autotenuta sul bocchettone.

**EN** Angle lockshield valve for iron pipe, with self-sealing on the tailpiece. Art. 101 without self-sealing on the tailpiece.

**FR** Té de réglage équerre pour tube fer, avec auto-étanchéité sur le raccord. Art. 101 sans auto-étanchéité sur le raccord.

**RU** Угловой запорный вентиль для железной трубы, с уплотнительным кольцом. Art. 101 БЕЗ уплотнительного кольца.

Art.	3/8"	1/2"	3/4"
101/1-03	10	10	10
101/1-04	10	10	10
101/1-05	10	10	10
101-03	10	10	10
101-04	10	10	10
101-05	10	10	10

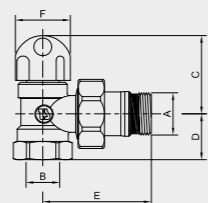

Art.	A	B	C	D	E	F
101/1-03	3/8"	3/8"	39	20	50	Ø27
101/1-04	1/2"	1/2"	39	23	54	Ø27
101/1-05	3/4"	3/4"	39	26	60	Ø27



102

ART.  
102/1

**IT** Valvola manuale diritta per tubo ferro, con autotenuta sul bocchettone. Art. 102 senza autotenuta sul bocchettone.

**EN** Manual straight valve for iron pipe, with self-sealing on the tailpiece. Art. 102 without self-sealing on the tailpiece.

**FR** Robinet manuel droit pour tube en fer, avec auto-étanchéité sur le raccord. Art. 102 sans auto-étanchéité sur le raccord.

**RU** Прямой ручной клапан для железной трубы, с уплотнительным кольцом. Art. 102 БЕЗ уплотнительного кольца.

Art.	3/8"	1/2"	3/4"
102/1-03	10	10	10
102/1-04	10	10	10
102/1-05	10	10	10
102-03	10	10	10
102-04	10	10	10
102-05	10	10	10

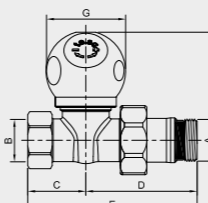

Art.	A	B	C	D	E	F	G
102/1-03	3/8"	3/8"	30	50	80	57	Ø39
102/1-04	1/2"	1/2"	28	54	82	57	Ø39
102/1-05	3/4"	3/4"	28	57	85	57	Ø39



103

ART.  
103/1

**IT** Detentore diritto per tubo ferro, con autotenuta sul bocchettone. Art. 103 senza autotenuta sul bocchettone.

**EN** Straight lockshield valve for iron pipe, with self-sealing on the tailpiece. Art. 103 without self-sealing on the tailpiece.

**FR** Té de réglage droit pour tube fer, avec auto-étanchéité sur le raccord. Art. 103 sans auto-étanchéité sur le raccord.

**RU** Прямой запорный вентиль для железной трубы, с уплотнительным кольцом. Art. 103 БЕЗ уплотнительного кольца.

Art.	3/8"	1/2"	3/4"
103/1-03	10	10	10
103/1-04	10	10	10
103/1-05	10	10	10
103-03	10	10	10
103-04	10	10	10
103-05	10	10	10

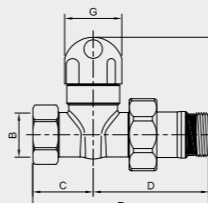

Art.	A	B	C	D	E	F	G
103/1-03	3/8"	3/8"	30	50	80	45	Ø27
103/1-04	1/2"	1/2"	28	54	82	45	Ø27
103/1-05	3/4"	3/4"	28	57	85	45	Ø27



104

ART.  
104/1

**IT** Valvola manuale ad angolo per tubo rame, plastica o multistrato, senza raccordo, con autotenuta sul bocchettone. Art. 104 senza autotenuta sul bocchettone.

**EN** Manual angle valve for copper, plastic or multilayer pipe, without fitting, with self-sealing on the tailpiece. Art. 104 without self-sealing on the tailpiece.

**FR** Robinet manuel équerre pour tubes cuivre, plastique ou multicouche sans raccord, avec auto-étanchéité sur le raccord. Art. 104 sans auto-étanchéité sur le raccord.

**RU** Угловой ручной клапан для медной, пластиковой или многослойной трубы, без фитинга, с уплотнительным кольцом. Art. 104 БЕЗ уплотнительного кольца.

Art.	3/8"	1/2"	3/4"
104/1-03	10	10	10
104/1-04	10	10	10
104/1-045	10	10	10
104-03	10	10	10
104-04	10	10	10
104-045	10	10	10

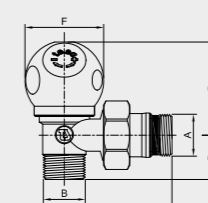

Art.	A	B	C	D	E	F
104/1-03	3/8"	1/2"	49	20	49	Ø39
104/1-04	1/2"	1/2"	49	23	56	Ø39
104/1-045	1/2"	3/4"	49	22	61	Ø39



105

ART.  
105/1

**IT** Detentore ad angolo per tubo rame, plastica o multistrato, senza raccordo, con autotenuta sul bocchettone. Art. 105 senza autotenuta sul bocchettone.

**EN** Angle lockshield valve for copper, plastic or multilayer pipe, without fitting, with self-sealing on the tailpiece. Art. 105 without self-sealing on the tailpiece.

**FR** Té de réglage équerre pour tubes cuivre, plastique ou multicouche, sans raccord, avec auto-étanchéité sur le raccord. Art. 105 sans auto-étanchéité sur le raccord.

**RU** Угловой запорный вентиль для медной, пластиковой или многослойной трубы, без фитинга, с уплотнительным кольцом. Art. 105 БЕЗ уплотнительного кольца.

Art.	3/8"	1/2"	3/4"
105/1-03	10	10	10
105/1-04	10	10	10
105/1-045	10	10	10
105-03	10	10	10
105-04	10	10	10
105-045	10	10	10

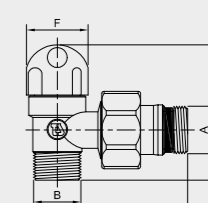

Art.	A	B	C	D	E	F
105/1-03	3/8"	1/2"	41	20	49	Ø27
105/1-04	1/2"	1/2"	41	23	56	Ø27
105/1-045	1/2"	3/4"	41	22	61	Ø27